

DIRECTION DISTRICTS KEY MAP

REVISIONS		
DATE	NAME	NO.
OCT. 1, 1996	LOUIS A. RAIMONDI, P.E., P.L.S.	10622
SEPT. 8, 1999	LOUIS A. RAIMONDI, P.E., P.L.S.	10622
DEC. 2000	LOUIS A. RAIMONDI, P.E., P.L.S.	10622
MAY 2001	LOUIS A. RAIMONDI, P.E., P.L.S.	10622
MAY 1, 2002	JOHN C. RICHARDSON, JR.	20789
APRIL 1, 2003	JOHN C. RICHARDSON, JR.	20789
DEC. 31, 2012	FRANK M. KRUPINSKI	37197

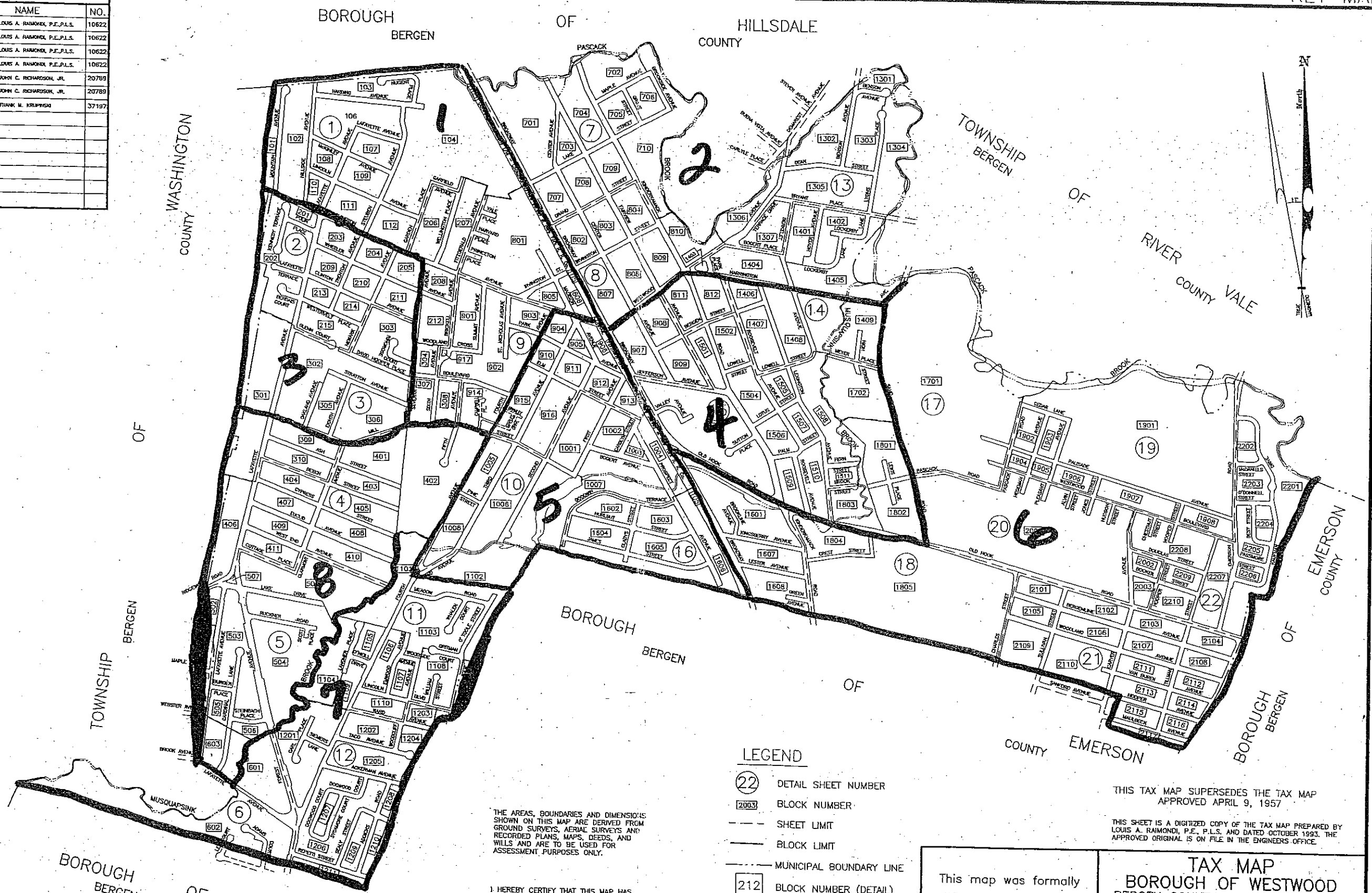

THE AREAS, BOUNDARIES AND DIMENSIONS SHOWN ON THIS MAP ARE DERIVED FROM GROUND SURVEYS, AERIAL SURVEYS AND RECORDED PLANS, MAPS, DEEDS, AND WILLS AND ARE TO BE USED FOR ASSESSMENT PURPOSES ONLY.

I HEREBY CERTIFY THAT THIS MAP HAS BEEN REVISED UNDER MY IMMEDIATE SUPERVISION AND COMPLIES WITH THE LAWS OF THE STATE OF NEW JERSEY

FRANK M. KRUPINSKI, INC. Lic. No. 37197

- LEGEND**
- ⊙ 22 DETAIL SHEET NUMBER
 - ⊠ 2003 BLOCK NUMBER
 - SHEET LIMIT
 - BLOCK LIMIT
 - MUNICIPAL BOUNDARY LINE
 - ⊠ 212 BLOCK NUMBER (DETAIL)
 - 15 LOT NUMBER (DETAIL)
 - BLOCK LIMIT (DETAIL)

THIS TAX MAP SUPERSEDES THE TAX MAP APPROVED APRIL 9, 1957

THIS SHEET IS A DIGITIZED COPY OF THE TAX MAP PREPARED BY LOUIS A. RAIMONDI, P.E., P.L.S. AND DATED OCTOBER 1993. THE APPROVED ORIGINAL IS ON FILE IN THE ENGINEERS' OFFICE.

This map was formally certified on April 18, 1994 signed by Ivan Haftkowsky and assigned Serial # 760.

TAX MAP
BOROUGH OF WESTWOOD
 BERGEN COUNTY NEW JERSEY
 SCALE: 1"=500' OCTOBER 1993
 LOUIS A. RAIMONDI, P.E., P.L.S.
 RAIMONDI ASSOCIATES, P.A.
 120 WOODLAND AVENUE
 WESTWOOD, N.J. 07675
 TO SHOW CONDITIONS AS OF DECEMBER 31, 2012

#1 Westwood House
 #2 Community Center

#3 Municipal Bldg.
 #4 Community Center

#5 Municipal Bldg.
 #6 Community Center

#7 MUNICIPAL Bldg
 #8 MUNICIPAL Bldg.

KEY MAP